

## Introducing the Embossing Square

The Embossing Square allows you to emboss the various motifs/patterns onto paper, aluminium or copper. Also to create 4 patterned borders, achieving a continuous embossed border design around the edges of your design, card or invitation.

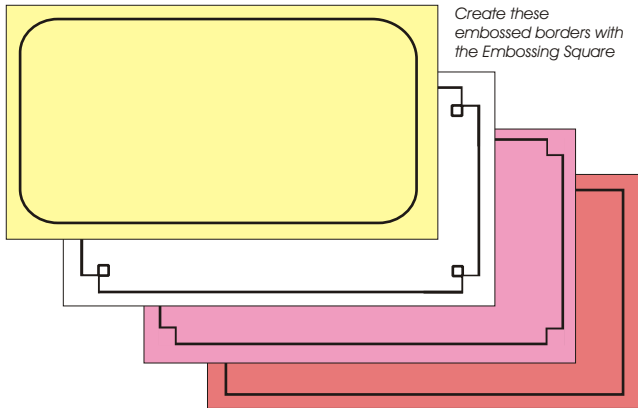
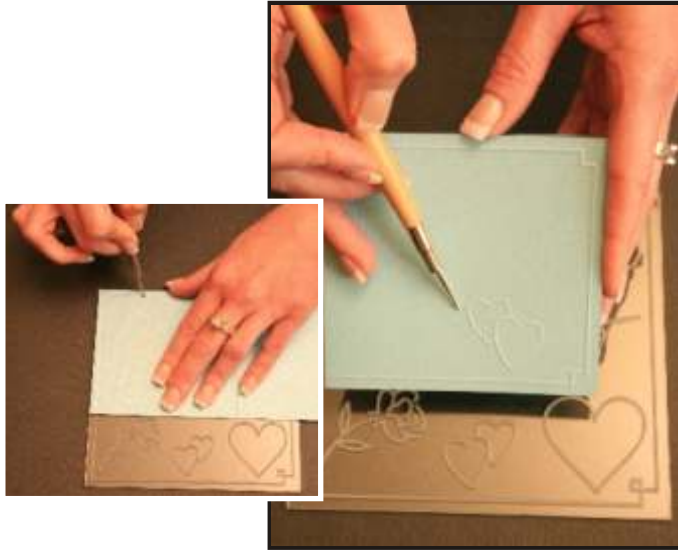

**"I love the Embossing Square because I am able to emboss beautiful borders onto my cards. It has added a whole new dimension to my card making and my customers love the effect"**

*Rosemary - Professional Card Maker*

## Easy to emboss borders



*Position corner of paper onto the desired corner pattern of the Embossing Square.*

*Ensure the edge of paper is square / flush to the edges of the Embossing Square.*



*Using your hand or fix into position with tape, hold the paper in position whilst embossing.*

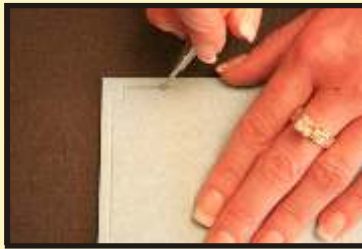

*Emboss the corner design including the straight lines either side, allowing enough length to be able to continue the embossed line into the next corner.*



*Rotate your paper and position into the same corner and continue by picking up the groove from the first line.*

*Continue until all edges are complete.*

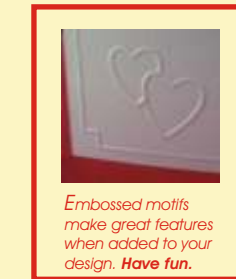

*These products are copyright protected.*

**Available from:**

**Paper  
indulgence**

471 Victoria Street, Brunswick West 3055